



# Energy Saver Valves



### Mechanical Characteristic

Body	: Aluminium
Orifice	: Refer to technical data
Ports	: BSP
Seals	: Nitrile Rubber
Weight	: Refer to technical data

### Operating Conditions

Media	: Compressed Air
Temperature Range	: +5° to +50°C
Pressure Range	: 0 to 10 bar
Leakage	: Bubble Tight
Flow (NLPM) at 5 bar	: Refer to technical data



### 1/4", BSP Energy Saving Valve ES2

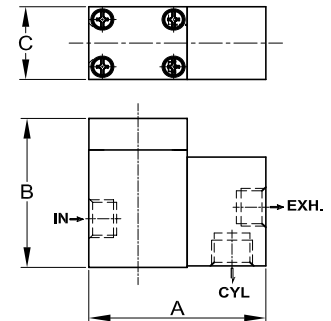

MODEL No.	SIZE BSP.	ORIFICE (mm)	SYMBOL	A	B	C	FLOW NLPM	WEIGHT (Kg.)	SEAL KIT No.
ES2	1/4"	Ø6.50		57.00	52.0	25.40	1100	0.16	SKES2

### 1/2", BSP Energy Saving Valve ES4

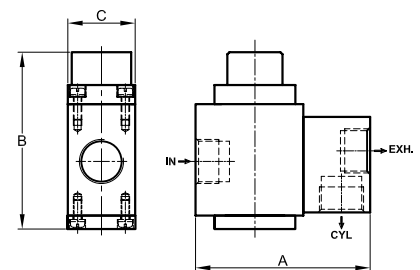

MODEL No.	SIZE BSP.	ORIFICE (mm)	SYMBOL	A	B	C	FLOW NLPM	WEIGHT (Kg.)	SEAL KIT No.
ES4	1/2"	Ø12.50		82.50	83.50	31.75	3000	0.30	SKES4

### 1/4" BSP Energy Saving Valve for Blow Gun ESB2

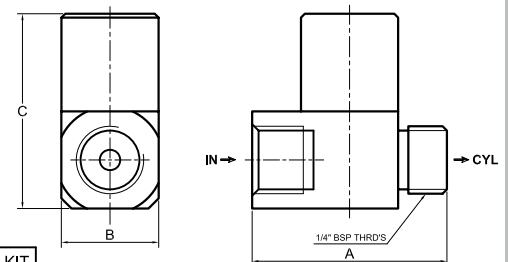

MODEL No.	SIZE BSP.	ORIFICE (mm)	SYMBOL	A	B	C	FLOW NLPM	WEIGHT (Kg.)	SEAL KIT No.
ESB2	1/4"	Ø3.00		38.10	19.05	38.10	300	0.04	SKESB2