



# Pilot Operated Check Valves



### Mechanical Characteristic

Body	: Aluminium
Orifice	: Refer to technical data
Ports	: BSP
Seals	: Nitrile Rubber
Weight	: Refer to technical data

### Operating Conditions

Media	: Compressed Air
Temperature Range	: +5° to + 50°C
Pressure Range	: 3 to 10 bar
Leakage	: Bubble Tight
Flow (NLPM) at 5 bar	: Refer to technical data



### 1/4", BSP Pilot Operate Check Valve PC2

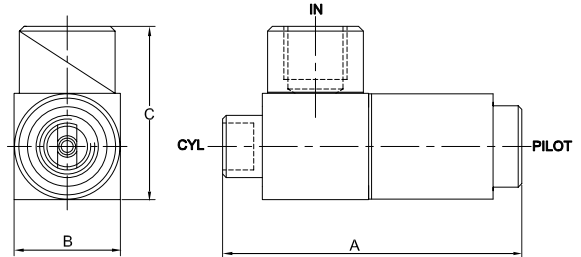

MODEL No.	SIZE BSP.	ORIFICE (mm)	SYMBOL	A	B	C	FLOW NLPM	WEIGHT (Kg.)	SEAL KIT No.
PC2	1/4"	Ø6.50		62.5	22.20	36.20	1100	0.06	SKPC2

### 1/2", BSP Pilot Operate Check Valve PC4

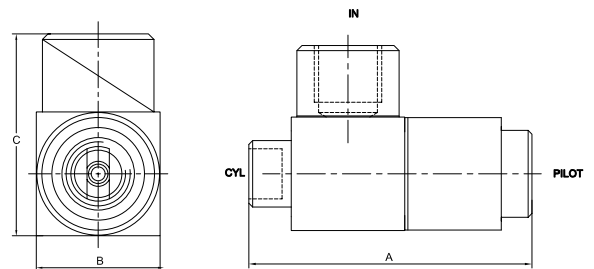

MODEL No.	SIZE BSP.	ORIFICE (mm)	SYMBOL	A	B	C	FLOW NLPM	WEIGHT (Kg.)	SEAL KIT No.
PC4	1/2"	Ø12.50		70.0	31.75	53.00	3000	0.15	SKPC4